

# CURRENT TRANSFORMERS

Model 56

Window Diameter 2.06"

**APPLICATION:**  
With ammeters, wattmeters, and cross current compensation.

**FREQUENCY:**  
50-400 Hz.

**INSULATION LEVEL:**  
0.6 kV. BIL 10 kV. full wave.



- Flexible leads are UL 1015 105 ° C, CSA approved, #16 AWG, 24" long.
- Non-standard length to be specified.
- Terminals are brass studs No. 8-32 UNC with one flat washer, lockwasher and regular nut.
- SFT case style also available as SFL with leads.
- Approximate weight: 0.6 lb.

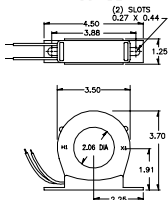
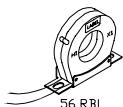
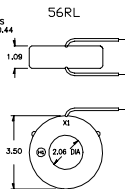
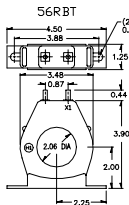
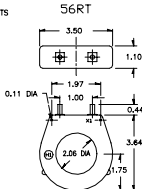
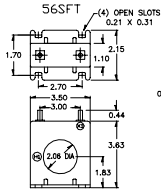
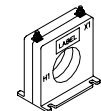

CATALOG NUMBER	CURRENT RATIO	ACCURACY AT 60 Hz	BURDEN VA AT 60 Hz
56 ** - 500	50:5	± 3 %	0.5
56 ** - 750	75:5	± 1 %	0.5
56 ** - 101	100:5	± 1 %	1.0
56 ** - 151	150:5	± 1 %	2.5
56 ** - 201	200:5	± 1 %	4.0
56 ** - 251	250:5	± 1 %	6.0
56 ** - 301	300:5	± 1 %	7.5
56 ** - 401	400:5	± 1 %	10.0
56 ** - 501	500:5	± 1 %	12.5
56 ** - 601	600:5	± 1 %	15.0
56 ** - 751	750:5	± 1 %	7.0
56 ** - 801	800:5	± 1 %	8.0
56 ** - 102	1000:5	± 1 %	10.0
56 ** - 122	1200:5	± 1 %	12.5

\*\* NOTE: When ordering, prefix Cat No. with model designation required, i.e. 56RL-101, 56RBL-251, etc.